

# ROYAL PATENT.

## GRANT.

*Liliuokalani, By the Grace of God, Queen of the Hawaiian Islands:*

*By this Her Royal Patent makes known to all men, that She hath for herself, her heirs and successors, this day granted and given unto*

*— Mary Antonio Sylva Rose. —*

*for the consideration of Five Hundred and Ten (\$100) Dollars paid into the Royal Exchequer, all that piece of Land situate at*

*— Kaliaopalea — Kalihii — in the Island of*

*— Oahu — and described as follows:*

*— Lot 3. —*

*Beginning at the South corner of this lot which is N. 51° 40' E true 323.6 feet from the junction of roads, as per Gov't Survey of Kaliaopalea lots, April 1889, and running by true Meridian*

*N. 51° 40' E. 150.3 feet, along Kamehameha road.*

*N. 42° 00' E. 237.2 "*

*S. 45° 00' E. 150.0 "*

*S. 42° 00' E. 227.8 "*

**waihona**  
**COPY**  
*to the initial point.*

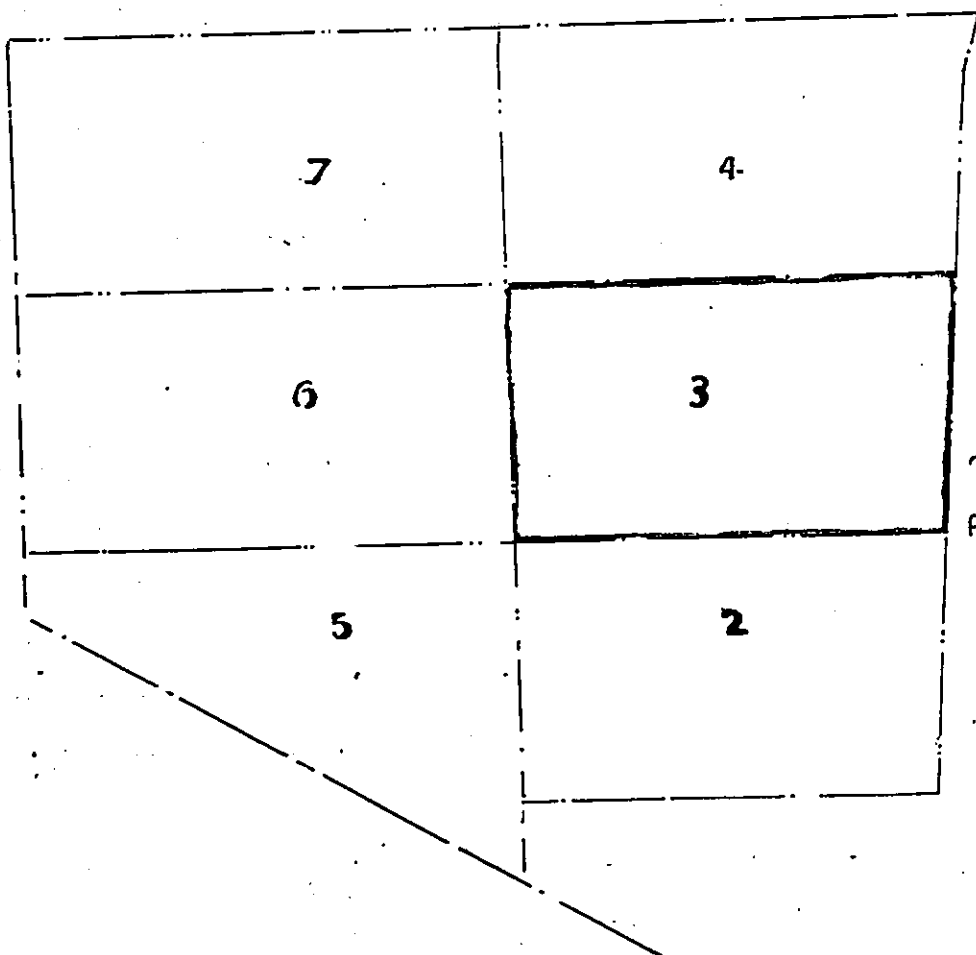

*Area 0.8 Acre.*